

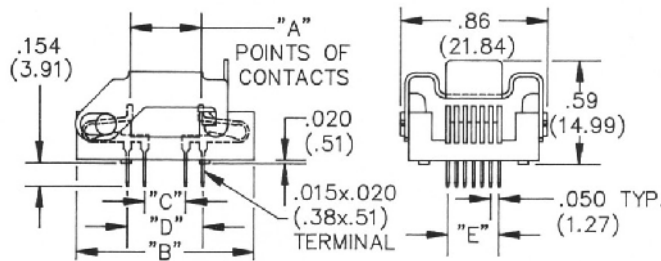

621 SERIES FOR 3/4" X 1" FLATPACK CARRIERS

- Standard 30 microinches of select gold plating over 50 microinches of nickel
- Easy-to-operate, stainless steel latch
- Latch stop prevents shorting if carrier is not in proper position
- Unique latch design provides positive contact without causing the carrier to "bow"
- Air slots allow maximum air circulation under the carrier and the IC device
- For temperatures up to 150°C

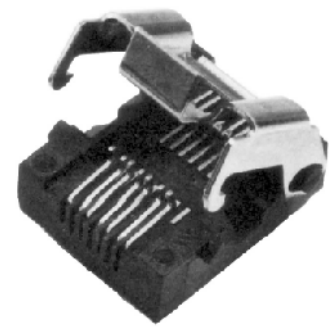

Part Number	Pin Count	Contact Material	Contact Plating	Dimensions (mm)			
				A	B	C	D
621-0142315	14	BeCu	Au/Ni	.406 (10.31)	1.035 (26.29)	.230 (5.84)	.430 (10.92)
621-0162315	16	BeCu	Au/Ni	.406 (10.31)	1.035 (26.29)	.230 (5.84)	.430 (10.92)
621-0182315	18	BeCu	Au/Ni	.634 (16.10)	1.215 (30.86)	.458 (11.63)	.658 (16.71)
621-0242315	24	BeCu	Au/Ni	.634 (16.10)	1.215 (30.86)	.458 (11.63)	.658 (16.71)

COMPACT VERSION ON .030" CENTERS

- 20, 22, 24, and 28-lead contactors on .030" centers
- Easy insertion of device leads
- For temperatures up to 150°C

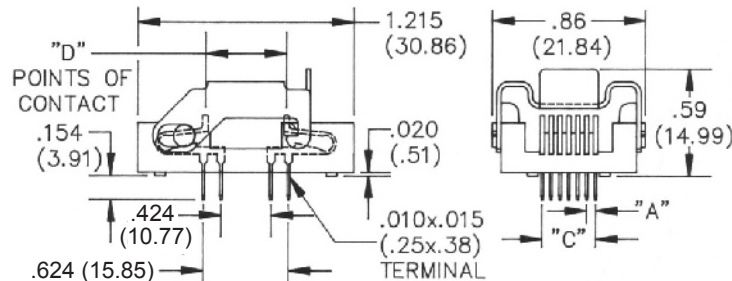
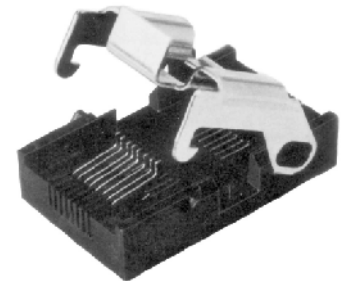

Part Number	Pin Count	Contact Material	Contact Plating	Plate Thickness	Dimensions (mm)				Notes
					A	B	C	D	
621-0202315-004	20	BeCu	Au/Ni	30 microinches	.030 (0.76)		.270 (6.86)	.600 (15.24)	Consult Factory
621-0222315-004	22	BeCu	Au/Ni	30 microinches	.030 (0.76)		.300 (7.62)	.600 (15.24)	Consult Factory
621-0242315-004	24	BeCu	Au/Ni	30 microinches	.030 (0.76)		.330 (8.38)	.600 (15.24)	Consult Factory
621-0282315-007	28	BeCu	Au/Ni	30 microinches	.030 (0.76)		.390 (9.91)	.660 (16.76)	Consult Factory