

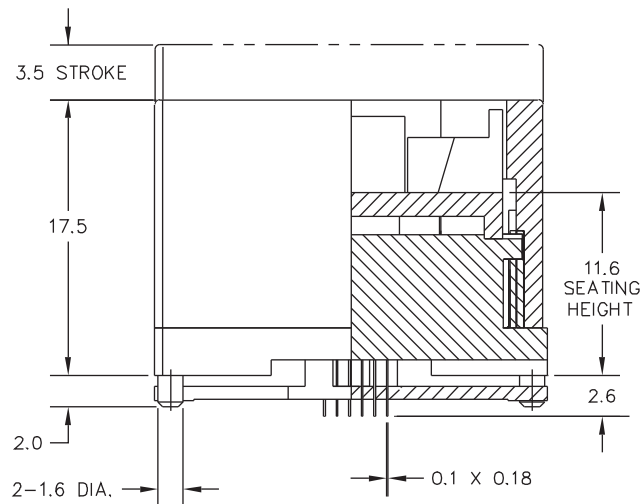

# 703 SERIES OPEN TOP CSP/FBGA

- Zero Insertion Force design for automatic loading
- Patented “Y” contact generates scrub at interface
- Mechanical ejection plate to eliminate device sticking
- For 0.75mm and 0.80mm pitch packages
- Thru hole design
- Adjustable for programming applications (“R” version)

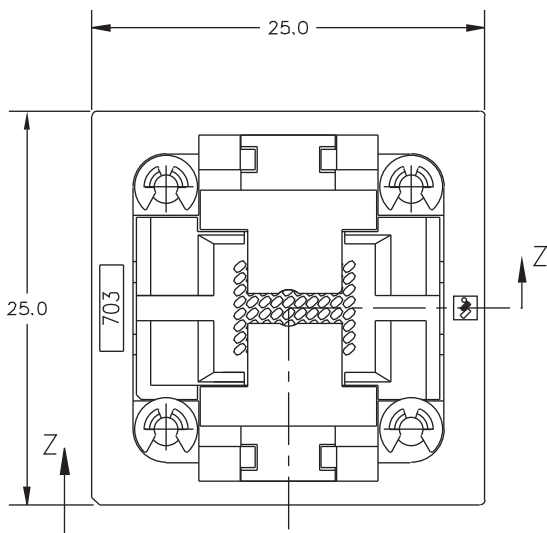
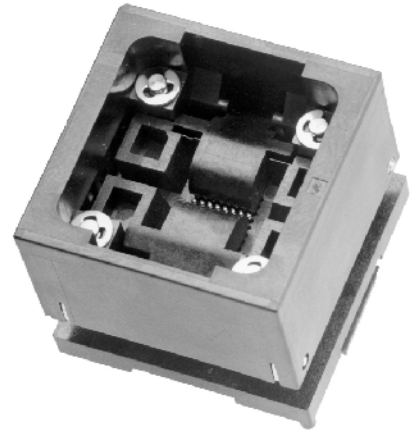

SECTION Z-Z  
AT FULL STROKE

## DESCRIPTION & ORDERING INFORMATION

**703 - X XXX - XX - S**

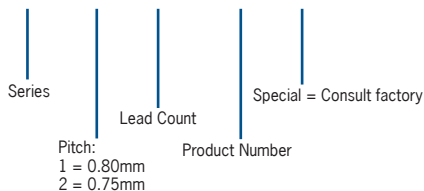

## MATERIALS & SPECIFICATIONS

- Socket Body: PES, PEI, LCP or Equivalent
- Contact: Beryllium Copper Alloy
- Contact Plating: 20 microinches gold over 40 microinches of nickel underplate in contact area; gold flash on solder tail
- Insulation Resistance: 1000 MΩ @ 500V DC
- Dielectric: 700V AC for 1 minute
- Temperature Rating: 150°C
- Contact Resistance: 100 mΩ max.
- Contact Normal Force: 13 grams
- Durability: 10,000 cycles min.



# 703 SERIES OPEN TOP CSP/FBGA

Pitch e (mm)	Lead Count	Package Size (mm)	Contact Matrix	Ball Dia. (mm)	Ball Height (mm)	Part Number
0.75	40	5.55 X 9.1	4 X 10	0.35	0.25	703-2040-01
	44	7.75 X 14.35	4 X 11	0.35	0.25	703-2044-01
	48	7.1 X 7.18	6 X 8	0.35	0.20 min.	703-2048-01
	48	7.75 X 7.3	6 X 8	0.35	0.25	703-2048-04
	48	9.616 X 6.85	6 X 8	0.35	0.25	703-2048-05
	48	6.62 X 6.8	6 X 8	0.35	0.25	703-2048-06
	48	7.95 X 8.95	6 X 8	0.30	0.25	703-2048-07
	48	10.4 X 7	6 X 8	0.35	0.20 min.	703-2048-08
	48	6.37 X 6.39	6 X 8	0.35	0.20 min.	703-2048-11
	48	10.5 X 6.39	6 X 8	0.35	0.20 min.	703-2048-12
	48	7 X 7	6 X 8	0.45	0.30	703-2048-13
	48	8 X 7	6 X 8	0.45	0.30	703-2048-14
	48	12 X 7	6 X 8	0.45	0.30	703-2048-15
	48	8.1 X 8.1	6 X 8	0.40/0.45	0.23 min.	703-2048-16
	48	12 X 7	6 X 8	0.30	0.20 min.	703-2048-17
	48	8.1 X 8.1	6 X 8	0.40/0.45	0.23 min.	703-2048-18
	48	8 X 10	6 X 8	0.35	0.27	703-2048-19
	48	11.1 X 8.1	6 X 8	0.40/0.45	0.35	703-2048-20
	48	11 X 8	6 X 8	0.40	0.25	703-2048-24
	56	11.1 X 8.1	7 X 8	0.40/0.45	0.22 min.	703-2056-01
0.80	40	7.95 X 14.95	4 X 10	0.30	0.25	703-1040-01
	48	6.15 X 8.15	6 X 8	0.40	0.40	703-1048-01
	48	5.95 X 8.95	6 X 8	0.40	0.40	703-1048-02
	48	7.95 X 8.95	6 X 8	0.40	0.40	703-1048-03
	48	7.95 X 13.95	6 X 8	0.45	0.36	703-1048-05
	48	5.95 X 8.95	6 X 8	0.40	0.30	703-1048-06
	48	6.15 X 8.15	6 X 8	0.30	0.25	703-1048-11
	48	10.1 X 8.1	6 X 8	0.45	0.35	703-1048-12
	48	8 X 10	6 X 8	0.45	0.30	703-1048-13-S
	48	7.95 X 8.95	6 X 8	0.30	0.25	703-1048-14
	48	7.95 X 8.95	6 X 8	0.30	0.25	703-1048-14-S
	48	5.95 X 8.95	6 X 8	0.30	0.25	703-1048-15
	48	5.95 X 8.95	6 X 8	0.30	0.25	703-1048-15-S
	48	6 X 12	6 X 8	0.30	0.25	703-1048-16
	48	6 X 12	6 X 8	0.30	0.25	703-1048-16-S
	48	11.1 X 8.1	6 X 8	0.45	0.35	703-1048-17
	48	8.1 X 8.1	6 X 8	0.45	0.392	703-1048-18
	48	6.05 X 9.05	6 X 8	0.45	0.33	703-1048-19
	49	7 X 7	7 X 7	0.46	0.36	703-1049-01
	49	6 X 6	7 X 7	0.48	0.30	703-1049-02

continued...



# 703 SERIES OPEN TOP CSP/FBGA

Pitch e (mm)	Lead Count	Package Size (mm)	Contact Matrix	Ball Dia. (mm)	Ball Height (mm)	Part Number
0.80	56	7.92 X 8.28	7 X 8	0.32	0.23	703-1056-01
	56	8 X 10	8 x 8	0.45	0.32	703-1056-03
	60	8.1 X 11.1	8 X 12	0.45	0.35	703-1060-02
	63	8 X 14	8 X 12	0.30	0.25	703-1063-02
	64	8.1 X 11.1	8 X 8	0.45	0.35	703-1064-01
	64	8.1 X 11.1	8 X 8	0.45	0.35	703-1064-01-S
	64	8.1 X 8.1	8 X 8	0.45	0.35	703-1064-02
	64	8.1 X 8.1	8 X 8	0.45	0.35	703-1064-02-S
	64	7.95 X 13.95	8 X 8	0.45	0.36	703-1064-03
	64	7.95 X 13.95	8 X 8	0.45	0.36	703-1064-03-S
	64	8 X 10	8 X 8	0.45	0.35	703-1064-04-S
	64	8 X 11	8 X 8	0.30	0.25	703-1064-05-S
	64	8 X 12	8 X 8	0.40	0.35	703-1064-06
	64	8.1 X 11.1	8 X 8	0.45	0.35	703-1064-07
	64	8.1 X 8.1	8 X 8	0.45	0.35	703-1064-08
	64	8 X 13	8 X 8	0.40	0.35	703-1064-09
	64	8 X 11	8 X 8	0.30	0.20 min.	703-1064-10-S
	64	8.1 X 12.1	8 X 8	0.45	0.35	703-1064-11
	72	8 X 11	8 X 12	0.45	0.35	703-1072-01
	80	8 X 14	8 X 10	0.45	0.35	703-1080-01
	84	8 X 11	8 X 12	0.45	0.35	703-1084-01
	88	8 X 11	8 X 12	0.45	0.35	703-1088-01
	96	8 X 11	8 X 12	0.45	0.35	703-1096-01