

Batteriekontakt / Battery Probe - UEBK-13009

Material (Material)

Gehäuse: LCP (UL94V-0)

(Frame: LCP UL94V-0)

Kolben: Messing, vergoldet

(Plunger: Brass, gold plated)

Stifthülse: Messing, vergoldet

(Barrel: Brass, gold plated)

Feder: Federstahl

(Spring: Spring Steel)

Elektrische Spezifikation (Electrical specification)

Nennstrom: 2 A

(Rated Current: 2 A)

Kontaktwiderstand: < 50 mΩ

(Contact Resistance: < 50 mΩ)

Mechanische Spezifikation (Mechanical specification)

Kontakte: 6

(No. of contacts: 6)

Max. Hub: 1,4 mm

(Max. travel: 1,4 mm)

Empfohlener Hub: 0,7 mm

(Recommended travel: 0,7 mm)

Federkraft: 1,5 N bei Empfohlenem Hub

(Spring Force: 1,5 N @ recommended travel)

Anschluss: SMD

(Connection: SMD)

Bestellinformation (Order Information)

Art. Nr. (Art. No.):

UEBK-13009

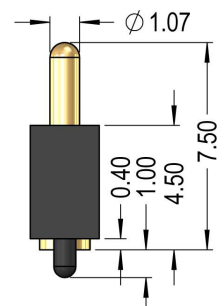
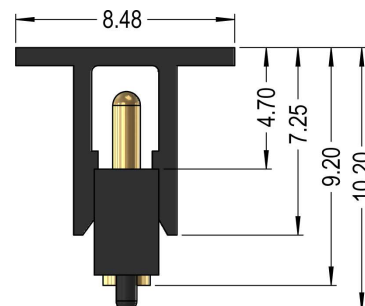
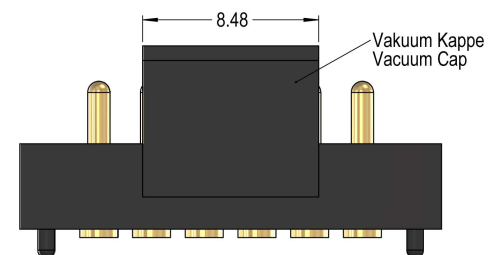
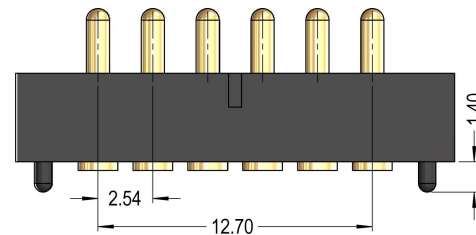
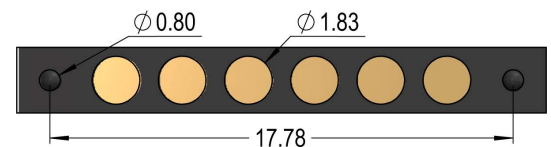
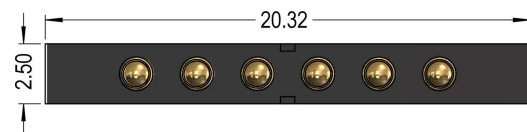
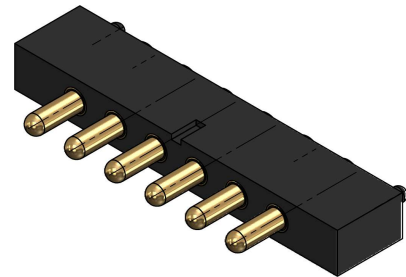

Batteriekontakt / Battery Probe - UEBK-13009 Tape / Reel

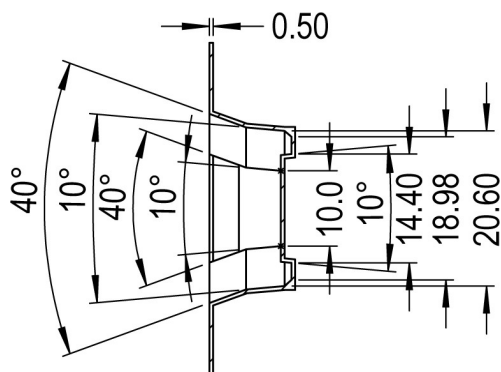
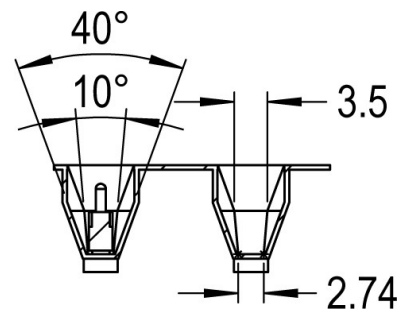
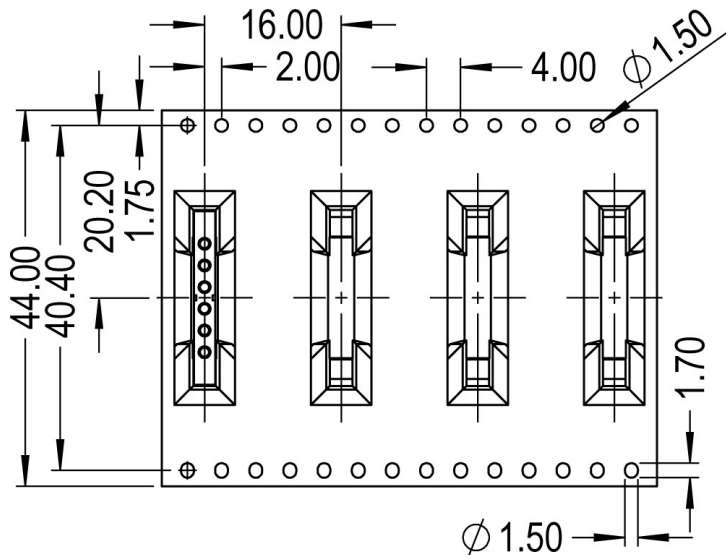

Mechanische Spezifikation (Mechanical specification)

Mindestbestückungsabstand: 8,9 mm

(Minimum mounting pitch: 8,9 mm)

Stückzahl: 350 je Rolle

(Quantity: 350 per Reel)

Bestellinformation (Order information)

Art. Nr.: UEBK-13280

(Art. No.: UEBK-13280)