

## Batteriekontakt / Battery Probe - UEBK-13365

### Material (Material)

Kolben: Messing, vergoldet

*(Plunger: Brass, gold plated)*

Stifthülse: Messing, vergoldet

*(Barrel: Brass, gold plated)*

Feder: Edelstahl

*(Spring: Stainless Steel)*

### Elektrische Spezifikation (Electrical specification)

Nennstrom: 2 A

*(Rated current: 2 A)*

Kontaktwiderstand: < 30 mΩ

*(Contact resistance: < 30 mΩ)*

### Mechanische Spezifikation (Mechanical specification)

Minimum Raster: 1,91 mm

*(Minimum Centers: 1,91 mm)*

Max. Hub: 0,55 mm

*(Max. travel: 0,55 mm)*

Empfohlener Hub: 0,5 mm

*(Recommended travel: 0,5 mm)*

Federkraft: 0,68 N bei Empfohlenem Hub

*(Spring Force: 0,68 N @ recommended travel)*

Anschluss: THT

*(Connection: THT)*

### Bestellinformation (Order information)

Art. Nr.: UEBK-13365

*(Art. No.: UEBK-13365)*

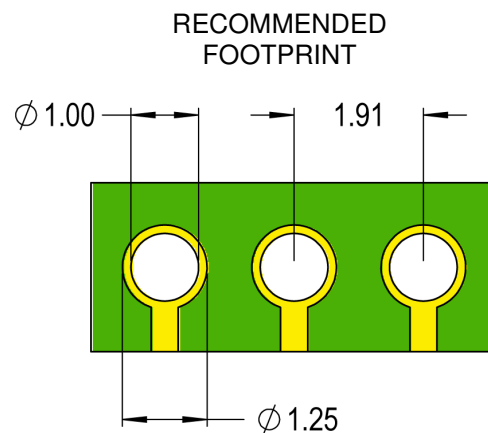
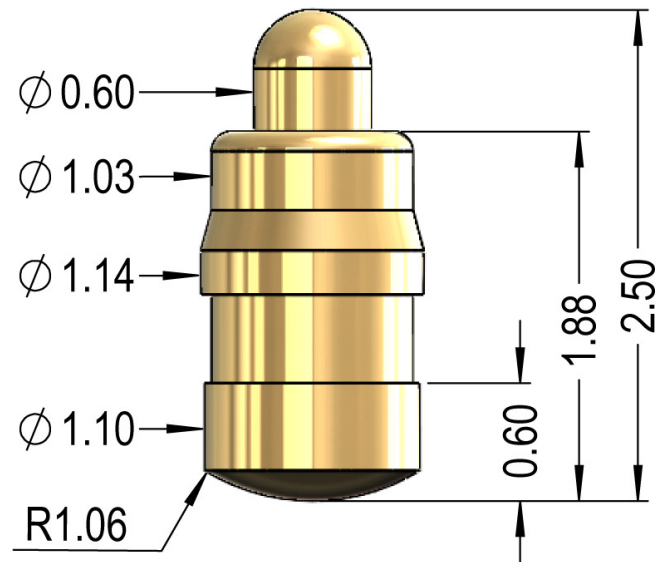

Stand 2/2021

Änderungen und Irrtümer vorbehalten. Angaben in Millimeter (mm) / Specifications subject to change without notice. Dimensions in Millimeter (mm)